

FOR SALE:

Singer Farm

1150 E. County Road 1800 N Sullivan, IL 61951

Sullivan Township
Moultrie County



\$12,750/acre

80 +/- total acres
Open lease for 2021
Average PI = 138.5
Yield 8 Year Average:
Corn: 226.0
Beans: 80.7



*Information in this flyer is believed to be accurate to the best of our knowledge.
We are not responsible for errors or omissions.

Soils Map

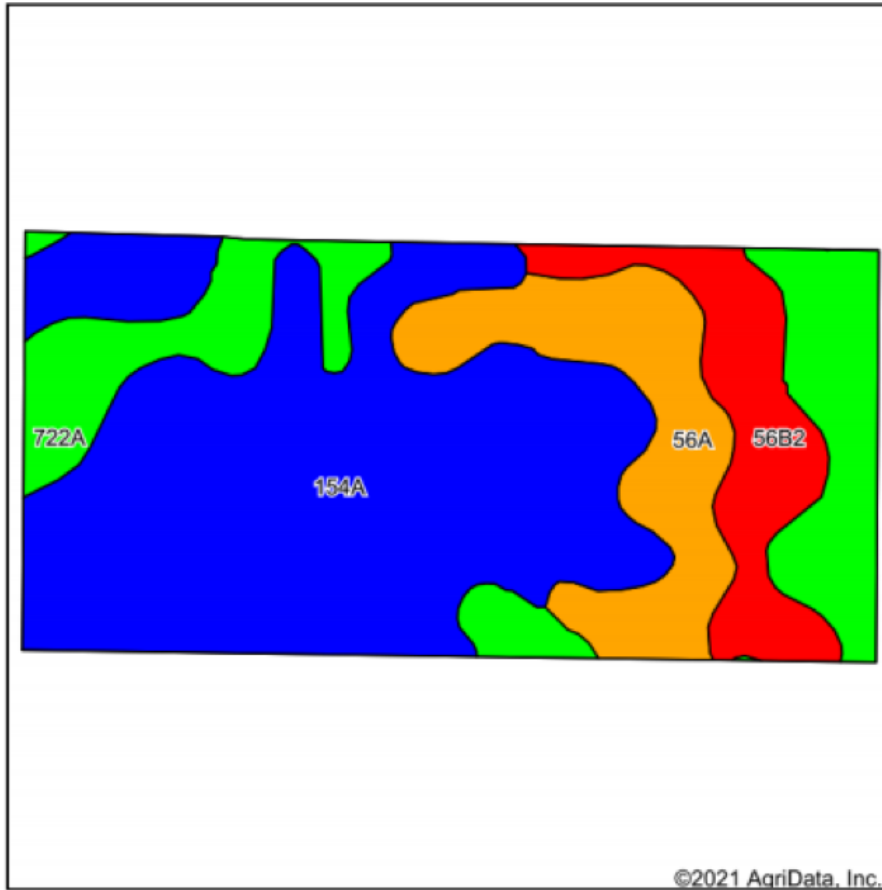

Soils data provided by USDA and NRCS.

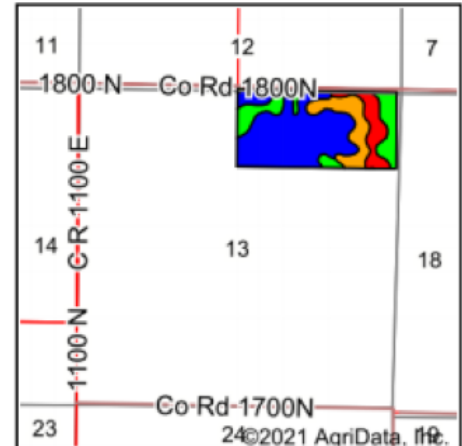

State: **Illinois**
 County: **Moultrie**
 Location: **12-14N-5E**
 Township: **Lovington**
 Acres: **78.28**
 Date: **3/3/2021**



Maps Provided By



surety
 CUSTOMIZED ONLINE MAPPING
 © AgriData, Inc. 2021 www.AgriDataInc.com



Area Symbol: IL139, Soil Area Version: 15							
Code	Soil Description	Acres	Percent of field	Il. State Productivity Index Legend	Corn Bu/A	Soybeans Bu/A	Crop productivity index for optimum management
154A	Flanagan silt loam, 0 to 2 percent slopes	42.30	54.0%		194	63	144
722A	Drummer-Milford silty clay loams, 0 to 2 percent slopes	15.83	20.2%		184	60	137
56A	Dana silt loam, 0 to 2 percent slopes	11.57	14.8%		180	56	131
**56B2	Dana silt loam, 2 to 5 percent slopes, eroded	8.58	11.0%		**171	**53	**124
Weighted Average					187.4	60.3	138.5

Table: Optimum Crop Productivity Ratings for Illinois Soil by K.R. Olson and J.M. Lang, Office of Research, ACES, University of Illinois at Champaign-Urbana. Version: 1/2/2012 Amended Table S2 B811

Crop yields and productivity indices for optimum management (B811) are maintained at the following NRES web site: <http://soilproductivity.nres.illinois.edu/>

** Indexes adjusted for slope and erosion according to Bulletin 811 Table S3

*c: Using Capabilities Class Dominant Condition Aggregation Method

Soils data provided by USDA and NRCS. Soils data provided by University of Illinois at Champaign-Urbana.

Soil Test
Spring 2017 by KSI
Average: 6.5 pH
59 P
291 K

80.00 Taxable Acres

77.03 FSA Certified/CRP Acres – 96.3% Tillable

2019 RE Tax Pd 2020: \$2,851.04 or \$35.64/ac

NORTH PART SULLIVAN



T.14N.-R.5E.

Refer to page 33 for keyed parcels

SEE PAGE 24

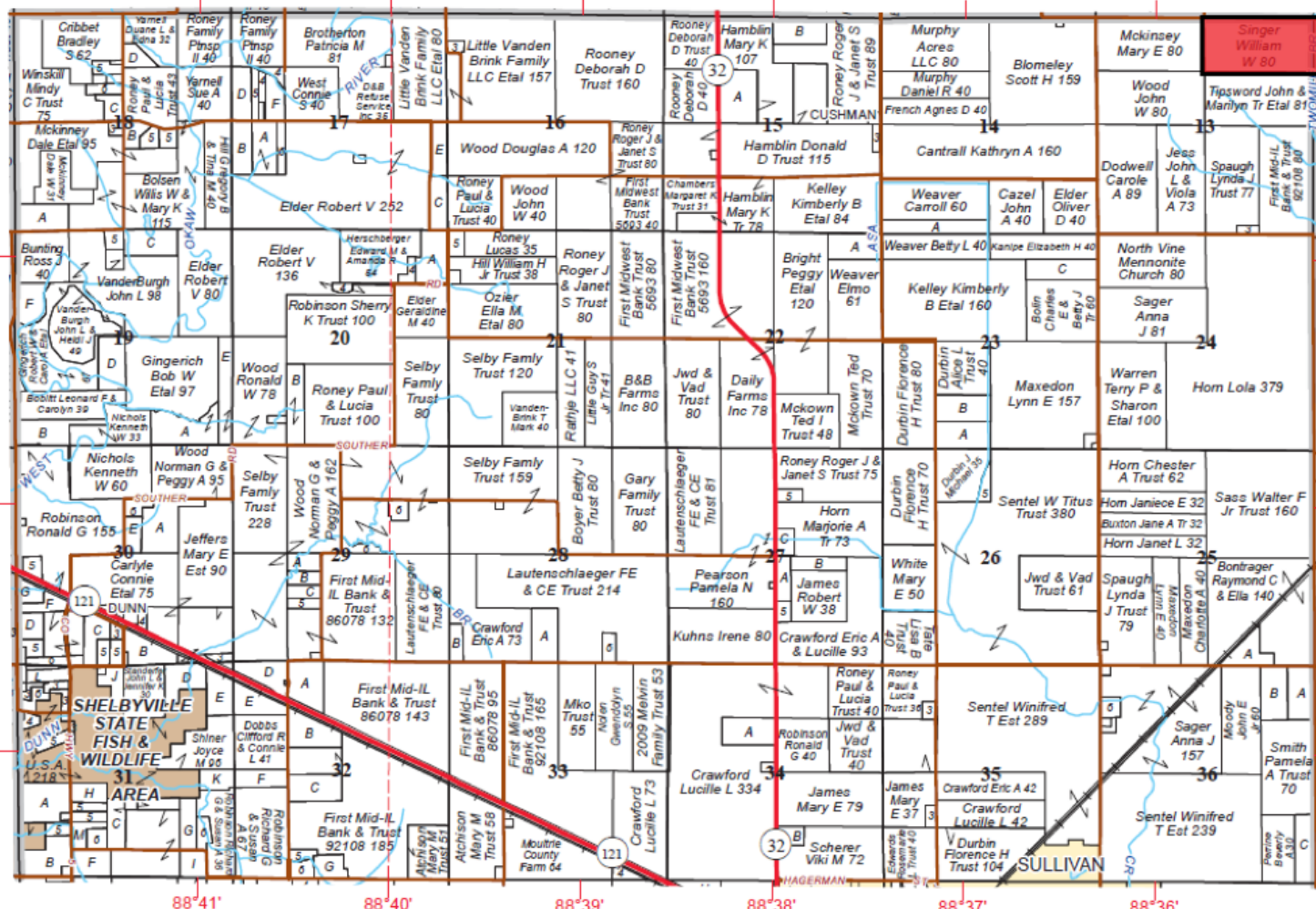

SEE PAGE 16

© 2019 Rockford Map Publs., Inc.
600E 700E 800E 900E 1000E 1100E 1200E

Moultrie County, IL



Littlefield Ag Group

Steve: 217-202-7950

Matt: 217-251-7067

Trey: 217-841-2542

Clayton: 217-474-1345